

INSTALACIÓN PLACA DE CALLE - OUTDOOR PANEL INSTALLATION - INSTALLATION DE LA PLATINE DE RUE - INSTALLATION DER TÜRSTATION - INSTALAÇÃO DA PLACA DE RUA

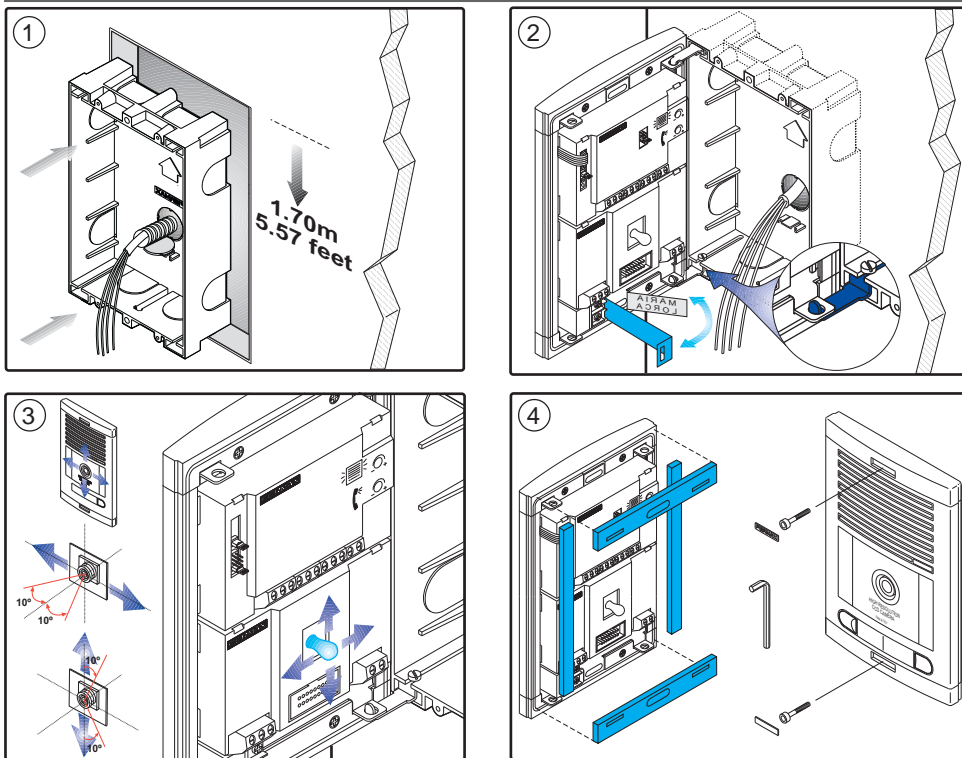

Características técnicas - Technical features - Caracteristiques techniques - Technische Eigenschaften - Características técnicas

	Alimentación - Power Supply - Alimentation - Stromversorgung - Alimentação	12 Vac/Vdc
	Consumo - Consumption - Consommation - Stromverbrauch - Consumo	
	en reposo - in standby - au repos - Im Bereitschaftsmodus - em repouso	90 mA
	audio activo - audio active - avec audio - Betriebszustand Audio - áudio activo	200 mA
	cámara - camera - caméra - Kamera - câmara	150 mA
iluminación - lighting - éclairage - Beleuchtung - iluminação	70 mA	
IP43		
Temperatura de funcionamiento - Operating Temperature Température de fonctionnement - Betriebstemperatur Temperatura de funcionamento		[0, +60 °C]
Potencia audio sentido vivienda-calle - Audio power from the apartment to the panel Puissance de l'audio sens poste-platine - Audio-Leistung in Richtung Türstation Potência áudio sentido rua		1 W
Potencia audio sentido calle-vivienda - Audio power from the panel to the apartment Puissance de l'audio sens platine-poste - Audio-Leistung in Richtung Telefon Potência áudio sentido telefone		0,25 W
Volumen regulable en ambos sentidos - Adjustable volume both ways Volume réglable dans les deux sens - Regulierbare Lautstärke in beiden Richtungen Volume regulável em ambos sentidos		

AJUSTES DE LA PLACA - PANEL ADJUSTMENT - RÉGLAGES DE LA PLATINE - EINSTELLUNGEN DER TÜRSTATION - AJUSTES DA PLACA

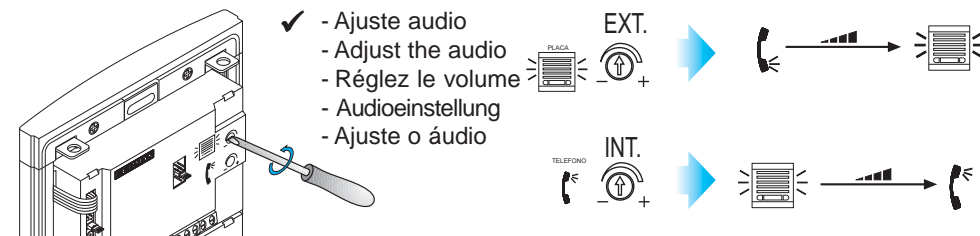

CONECTORES PLACA - PANEL CONNECTORS - CONNECTEURS PLATINE - ANSCHLÜSSE TÜRSTATION - CONECTORES DA PLACA

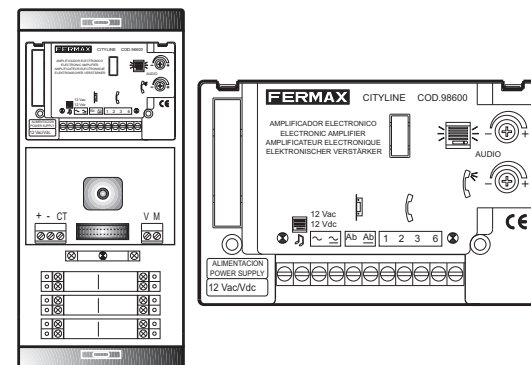

- E Conectores Placa:**
- Bornas de video, (coaxial).  
V: vivo  
M: malla  
Ct: activación telecamara (10 Vdc)  
+, -: alimentación (18 Vdc).
  - Bornas de Conexión del sistema:  
+, -: alimentación (12 Vac/Vdc).  
Ab, Ab: conexión abrepuertas  
1, 2, 3, 6: comunes audio
  - Conexión iluminación pulsadores.
  - Monitorización llamada.

- EN Panel Connectors:**
- Video terminals (coaxial).  
V: live  
M: shield  
Ct: camera activation (10 Vdc)  
+, -: power supply (18 Vdc).
  - System connection terminals:  
+, -: power supply (12 Vac/Vdc).  
Ab, Ab: door-opener connection  
1, 2, 3, 6: commons for audio
  - Light connection.
  - Call Monitoring.

- F Connecteurs platine:**
- Bornes vidéo (câble coaxial).  
V: vif  
M: maille  
Ct: activation caméra (10 Vdc)  
+, -: alimentation (18 Vdc).
  - Bornes de raccordement du système.  
+, -: alimentation (12 Vac/Vdc).  
Ab, Ab: connexion gâche électrique  
1, 2, 3, 6: communs d'audio
  - Raccordement éclairage boutons-poussoirs.
  - monitorisation.

- D Anschlüsse Türstation:**
- Video-Klemmen (Koaxial)  
V: Kern  
M: Schirm  
Ct: Aktivierung der Kamera (10 VDC)  
+, -: Stromversorgung (18 Vdc).
  - Bornas de Conexión del sistema:  
+, -: Stromversorgung (12 Vac/Vdc).  
Ab, Ab: Verbindung Türöffner  
1, 2, 3, 6: gemeinsame
  - Anschluss Hintergrundbeleuchtung Tasten
  - Kontrollabhören.

- P Conectores Placa:**
- Terminais de vídeo (coaxial).  
V: vivo  
M: malha  
Ct: activação telecamara (10 Vdc)  
+, -: alimentação (18 Vdc).
  - Bornas de Conexión del sistema:  
+, -: alimentação (12 Vac/Vdc).  
Ab, Ab: ligação do trinco  
1, 2, 3, 6: comuns de áudio
  - Ligação iluminação botões.
  - Monitorização da chamada.

